



• HANDCRAFTED LOG & TIMBER FRAMED STRUCTURES •

The Snow Valley Plan

3 Bedrooms, 4 Baths, Garage

606 Ridge Crest Circle
 Borden, Indiana, USA 47106
 812.246.1444 Office 812.246.1377 Fax
 info@WhiteEagleBuildingSystems.com Email

www.WhiteEagleBuildingSystems.com Web

Architectural Package Selections

- Handcrafted Log
- Log Post & Beam
- MillCrafted Log
- Timber Framed
- Panelized
- TimberCrafted
- CedarCrafted
- ValueCrafted

Available Services

- Architectural Design
- Planning & Budget
- Financial Assistance
- Shell Labor
- Turnkey Construction

Events

- Log Structure Raisings
- Timber Frame Raisings
- Other Shell Raisings
- Planning Seminars
- Open House
- Home Shows

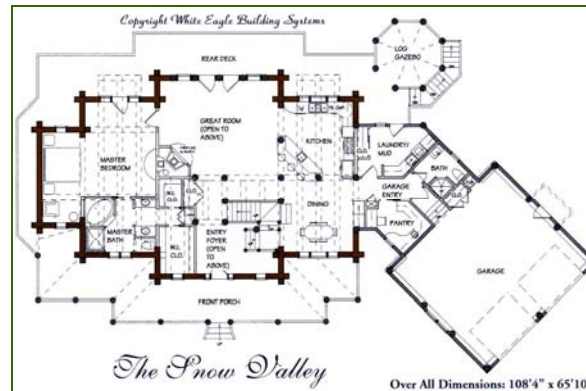

First Floor

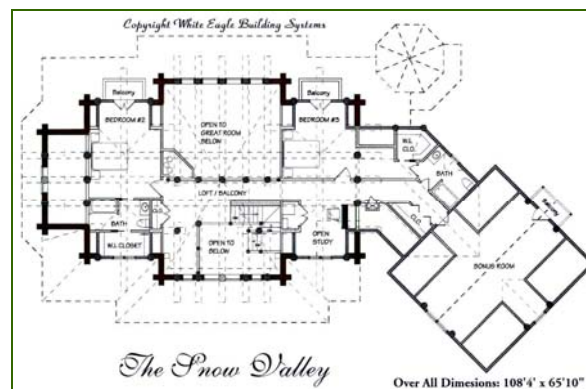

Second Floor

The Snow Valley

This was the first design in White Eagle's popular **Yankee Handcrafter's Series**. This plan offers excellent layout, great curb appeal, and a number of popular features and amenities.

Full scribe log work displays the art of handcrafting large log timbers in exacting joinery, while the open floor plan always remains a favorite.

From our **Handcrafter's Selection**, premium materials, affordable pricing.

1st Floor: 2,372 sq. ft Total Area: 3,703 sq. ft.
 2nd floor: 1,331 sq. ft. Package Price: Call For Prices